

The Company Secretary  
Derwen Plant Ltd  
Neath Abbey Wharf  
Neath Abbey  
Neath  
SA10 6BL

**Our ref: EPR/FP3893SF**

**Date: 9<sup>th</sup> March 2010**

Dear Sir/Madam

**Issue of standard permit**

**Permit reference:** EPR/FP3893SF

**Applicant:** Derwen Plant Ltd

**Standard facility:** Derwen Plant Ltd, Neath Abbey Wharf, Neath Abbey, Neath, SA10 6BL

I enclose:

1. a copy of the permit
2. the standard rules list SR2008No3\_75kte
3. decision document

To view a copy of Getting the basics right – how to comply with your environmental permit please use the following link to our website;

<http://publications.environment-agency.gov.uk/pdf/GEHO0209BPHU-e-e.pdf>

You need to submit quarterly returns on waste movements. All returns required by your permit must be sent to;

The Environment Agency, National Operator Returns Team, Quadrant 2,  
99 Parkway Avenue, Sheffield, S9 4WF.

Alternatively, please email your Excel spreadsheet to;

[National-operator-returns@environment-agency.gov.uk](mailto:National-operator-returns@environment-agency.gov.uk).

The spreadsheet can be obtained from our website using the following link;

<http://www.environment-agency.gov.uk/business/topics/waste/32176.aspx>

If you have any questions related to this permit, please phone the Permitting Support Centre on 08708 506506 or email [richard.toseland@environment-agency.gov.uk](mailto:richard.toseland@environment-agency.gov.uk).

Yours sincerely

**Richard Toseland**  
**Permitting Support Advisor**

Environment Agency, PSC, EP Team, Quadrant 2, 99 Parkway Avenue, Sheffield, S9 4WF  
Customer services line: 08708 506 506  
Email: [enquiries@environment-agency.gov.uk](mailto:enquiries@environment-agency.gov.uk)  
[www.environment-agency.gov.uk](http://www.environment-agency.gov.uk)



## **Standard rules SR2008No3\_75kte - household, commercial and industrial waste transfer station with treatment**

### **Introductory note**

This introductory note does not form part of these standard rules

When referred to in an environmental permit, these rules will allow the operator to operate a Household, Commercial and Industrial Waste Transfer Station with waste treatment at a specified location, provided that the permitted activities are not carried out within 500 metres of a European Site<sup>1</sup>, Ramsar site or a Site of Special Scientific Interest (SSSI). Furthermore, specified waste cannot be treated outside a building within a specified Air Quality Management Area (AQMA)<sup>2</sup>.

Permitted wastes are limited to non-hazardous wastes and do not include hazardous wastes such as asbestos. The total quantity of waste that can be accepted at a site under these rules must be less than 75,000 tonnes a year. With the exception of specified waste, all bulking, transfer or treatment of non-hazardous waste must be carried out inside a building. Wastes can be bulked up for disposal or recovery elsewhere and can also be treated by sorting, separation, screening, baling, shredding, crushing and compaction. These rules will not permit the burning of any wastes, either in the open, inside buildings or in any form of incinerator.

These rules do not allow any point source emission into surface waters or groundwater. However, under the fugitive emissions of substances rule:

- Liquids may be discharged into a sewer subject to a consent issued by the local water company.
- Liquids may be taken off-site in a tanker for disposal or recovery.
- Clean surface water from roofs, or from areas of the site that are not being used in connection with storing and treating waste, may be discharged directly to surface waters, or to groundwater by seepage through the soil via a soakaway.

---

<sup>1</sup> A candidate or Special Area of Conservation (cSAC or SAC) and proposed or Special Protection Area (pSPA or SPA) in England and Wales.

<sup>2</sup> An Air Quality Management Area which has been designated due to concerns about particulate matter in the form of PM<sub>10</sub>.

**End of introductory note**

---

# Rules

## 1 – Management

### 1.1 General management

1.1.1 The activities shall be managed and operated:

- (a) in accordance with a management system, which identifies and minimises risks of pollution, including those arising from operations, maintenance, accidents, incidents, non-conformances and closure and those drawn to the attention of the operator as a result of complaints; and
- (b) by sufficient persons who are competent in respect of the responsibilities to be undertaken by them in connection with the operation of the activities.

1.1.2 Records demonstrating compliance with rule 1.1.1 shall be maintained.

1.1.3 Any persons having duties that are or may be affected by the matters set out in these standard rules shall have convenient access to a copy of it kept at or near the place where those duties are carried out.

1.1.4 The operator shall comply with the requirements of an approved competence scheme or shall hold an appropriate certificate of technical competence or other approval issued by the Agency.

### 1.2 Accident management plan

1.2.1 The operator shall:

- (a) maintain and implement an accident management plan;
- (b) review and record at least every 4 years or as soon as practicable after an accident, (whichever is the earlier) whether changes to the plan should be made;
- (c) make any appropriate changes to the plan identified by a review.

## 2 – Operations

### 2.1 Permitted activities

2.1.1 The operator is authorised to carry out the activities specified in table 2.1 below ("the activities").

Table 2.1 activities	
Description of activities	Limits of activities
<p><b>D15:</b> Storage pending any of the operations numbered D1 to D14 (excluding temporary storage, pending collection, on the site where it is produced)</p> <p><b>R13:</b> Storage of wastes pending any of the operations numbered R1 to R12 (excluding temporary storage, pending collection, on the site where it is produced)</p> <p><b>D14:</b> Repackaging prior to submission to any of the operations numbered D1 to 13</p> <p><b>D9:</b> Physico-chemical treatment not specified elsewhere in Annex IIA which results in final compounds or mixtures which are discarded by means of any of the operations numbered D1 to D8 and D10 to D12</p> <p><b>R3:</b> Recycling/reclamation of organic substances which are not used as solvents</p> <p><b>R4:</b> Recycling/reclamation of metals and metal compounds</p> <p><b>R5:</b> Recycling/reclamation of other inorganic materials</p>	<p>Treatment consisting only of manual sorting, separation, screening, baling, shredding, crushing or compaction of waste into different components for disposal, (no more than 50 tonnes per day) or recovery.</p> <p>No more than a total of 50 tonnes of intact and shredded waste vehicle tyres (waste codes 16 01 03 and 19 12 04) shall be stored at the site.</p>

## 2.2 Waste acceptance

### 2.2.1 Waste shall only be accepted if:

- (a) it is of a type and quantity listed in table 2.2 below; and
- (b) it conforms to the description in the documentation supplied by the producer and holder.

Table 2.2. Waste types and quantities	
<p><b>Maximum Quantities</b></p> <p>The total quantity of waste accepted at the site shall be less than 75,000 tonnes a year.</p>	
<p><b>Exclusions</b></p> <p>Wastes having any of the following characteristics shall not be accepted:</p> <ul style="list-style-type: none"> <li>• Consisting solely or mainly of dusts, powders or loose fibres</li> <li>• Wastes that are in a form which is either sludge or liquid</li> </ul>	
<b>Waste Code</b>	<b>Description</b>

Table 2.2. Waste types and quantities

01 01 01	wastes from mineral metalliferous excavation
01 01 02	wastes from mineral non-metalliferous excavation
01 03 06	tailings other than those mentioned in 01 03 04 and 01 03 05
01 03 09	red mud from alumina production other than the wastes mentioned in 01 03 07
01 04 08	waste gravel and crushed rocks other than those mentioned in 01 04 07
01 04 09	waste sand and clays
01 04 11	wastes from potash and rock salt processing other than those mentioned in 01 04 07
01 04 12	fallings and other wastes from washing and cleaning of minerals other than those mentioned in 01 04 07 and 01 04 11
01 04 13	wastes from stone cutting and sawing other than those mentioned in 01 04 07
02 01 03	plant-tissue waste
02 01 04	waste plastics (except packaging)
02 01 07	wastes from forestry
02 01 10	waste metal
02 02 03	materials unsuitable for consumption or processing
02 03 04	materials unsuitable for consumption or processing
02 04 01	soil from cleaning and washing beet
02 04 02	off-specification calcium carbonate
02 05 01	materials unsuitable for consumption or processing
02 06 01	materials unsuitable for consumption or processing
02 06 02	wastes from preserving agents
02 07 01	wastes from washing, cleaning and mechanical reduction of raw materials
02 07 02	wastes from spirits distillation
02 07 04	materials unsuitable for consumption or processing
03 01 01	waste bark and cork
03 01 05	sawdust, shavings, cuttings, wood, particle board and veneer other than those mentioned in 03 01 04

03 03 01	waste bark and wood
03 03 07	mechanically separated rejects from pulping of waste paper and cardboard
03 03 08	wastes from sorting of paper and cardboard destined for recycling
03 03 10	Fibre rejects, fibre-, filler- and coating-sludges from mechanical separation
WASTE FROM THE PULPING OF WOOD AND PAPER PULPES	
04 01 08	waste tanned leather (blue sheetings, shavings, cuttings, buffing dust) containing chromium
04 01 09	wastes from dressing and finishing
WASTE FROM THE TANNING OF LEATHER	
04 02 21	wastes from unprocessed textile fibres
04 02 22	wastes from processed textile fibres
WASTE FROM THE MANUFACTURE OF TEXTILE FIBRES	
06 09 02	phosphorous slag
06 09 04	calcium-based reaction wastes other than those mentioned in 06 09 03
WASTE FROM THE MANUFACTURE OF FERTILISERS	
06 11 01	calcium-based reaction wastes from titanium dioxide production
WASTE FROM THE MANUFACTURE OF PIGMENTS AND DYES	
07 02 13	waste plastic
WASTE FROM THE MANUFACTURE OF PLASTICS	
09 01 07	photographic film and paper containing silver or silver compounds
09 01 08	photographic film and paper free of silver or silver compounds
09 01 10	single-use cameras without batteries
09 01 12	single-use cameras containing batteries other than those mentioned in 09 01 11
WASTE FROM MULTIMEDIA INDUSTRIES	
10 01 01	bottom ash, slag and boiler dust (excluding boiler dust mentioned in 10 01 04)
10 01 05	calcium-based reaction wastes from flue-gas desulphurisation in solid form
10 01 07	calcium-based reaction wastes from flue-gas desulphurisation in sludge form
10 01 15	bottom ash, slag and boiler dust from co-incineration other than those mentioned in 10 01 14
10 01 19	wastes from gas cleaning other than those mentioned in 10 01 05, 10 01 07 and 10 01 18
10 01 24	sands from fluidised beds
WASTE FROM THE MANUFACTURE OF FERROUS METALS	
10 02 01	wastes from the processing of slag
10 02 02	unprocessed slag
10 02 08	solid wastes from gas treatment other than those mentioned in 10 02 07
10 02 10	mill scales
10 02 14	filter cakes from gas treatment other than those mentioned in 10 02 13
10 02 15	other filter cakes
WASTE FROM THE MANUFACTURE OF NON-FERROUS METALS	
10 03 02	anode scraps
10 03 05	waste alumina
10 03 16	skimmings other than those mentioned in 10 03 15
10 03 18	carbon-containing wastes from anode manufacture other than those mentioned in 10 03 17
10 03 24	solid wastes from gas treatment other than those mentioned in 10 03 23

10 03 26	filter cakes from gas treatment other than those mentioned in 10 03 25
10 03 28	wastes from cooling-water treatment other than those mentioned in 10 03 27
10 03 30	wastes from treatment of salt slags and black drosses other than those mentioned in 10 03 29
10 04 10	wastes from cooling-water treatment other than those mentioned in 10 04 09
10 05 01	slags from primary and secondary production
10 05 09	wastes from cooling-water treatment other than those mentioned in 10 05 08
10 05 11	dross and skimmings other than those mentioned in 10 05 10
10 06 01	slags from primary and secondary production
10 06 02	dross and skimmings from primary and secondary production
10 06 10	wastes from cooling-water treatment other than those mentioned in 10 06 09
10 07 01	slags from primary and secondary production
10 07 02	dross and skimmings from primary and secondary production
10 07 03	solid wastes from gas treatment
10 07 05	filter cakes from gas treatment
10 07 08	wastes from cooling-water treatment other than those mentioned in 10 07 07
10 08 09	other slags
10 08 11	dross and skimmings other than those mentioned in 10 08 10
10 08 13	carbon-containing wastes from anode manufacture other than those mentioned in 10 08 12
10 08 14	anode scrap
10 08 18	filter cakes from flue-gas treatment other than those mentioned in 10 08 17
10 08 20	wastes from cooling-water treatment other than those mentioned in 10 08 19
10 09 03	furnace slag
10 09 06	casting cores and moulds which have not undergone pouring other than those mentioned in 10 09 05
10 09 08	casting cores and moulds which have undergone pouring other than those mentioned in 10 09 07
10 09 14	waste binders other than those mentioned in 10 09 13
10 09 16	waste crack-indicating agent other than those mentioned in 10 09 15
10 10 03	furnace slag
10 10 06	casting cores and moulds which have not undergone pouring, other than those mentioned in 10 10 05
10 10 08	casting cores and moulds which have undergone pouring, other than those mentioned in 10 10 07
10 10 14	waste binders other than those mentioned in 10 10 13
10 10 16	waste crack-indicating agent other than those mentioned in 10 10 15
10 11 03	waste glass-based fibrous materials
10 11 10	waste preparation mixture before thermal processing, other than those mentioned in 10 11 09
10 11 12	waste glass other than those mentioned in 10 11 11
10 11 16	solid wastes from flue-gas treatment other than those mentioned in 10 11 15
10 11 18	filter cakes from flue-gas treatment other than those mentioned in 10 11 17

10 12 01	waste preparation mixture before thermal processing
10 12 05	filter cakes from gas treatment
10 12 06	discarded moulds
10 12 08	waste ceramics, bricks, tiles and construction products (after thermal processing)
10 12 10	solid wastes from gas treatment other than those mentioned in 10.12.09
10 12 12	wastes from glazing other than those mentioned in 10.12.11
10 13 01	waste preparation mixture before thermal processing
10 13 04	wastes from calcination and hydration of lime
10 13 07	filter cakes from gas treatment
10 13 10	wastes from asbestos-cement manufacture other than those mentioned in 10 13 09
10 13 11	wastes from cement-based composite materials other than those mentioned in 10 13 09 and 10 13 10
10 13 13	solid wastes from gas treatment other than those mentioned in 10 13 12
10 13 14	waste concrete
11 01 10	filter cakes other than those mentioned in 11 01 09
11 01 14	degreasing wastes other than those mentioned in 11 01 13
11 02 03	wastes from the production of anodes for aqueous electrolytical processes
11 02 06	wastes from copper hydrometallurgical processes other than those mentioned in 11 02 05
11 05 01	hard zinc
11 05 02	zinc ash
12 01 01	ferrous metal filings and turnings
12 01 03	non-ferrous metal filings and turnings
12 01 05	plastics shavings and turnings
12 01 13	welding wastes
12 01 17	waste blasting material other than those mentioned in 12 01 16
12 01 21	spent grinding bodies and grinding materials other than those mentioned in 12 01 20
15 01 01	paper and cardboard packaging
15 01 02	plastic packaging
15 01 03	wooden packaging
15 01 04	metallic packaging
15 01 05	composite packaging
15 01 06	mixed packaging
15 01 07	glass packaging
15 01 09	textile packaging



15 02 03	absorbents, filter materials, wiping cloths and protective clothing other than those mentioned in 15 02 02
16 01 03	end-of-life tyres
16 02 14	discarded equipment other than those mentioned in 16 02 09 to 16 02 13
16 02 16	components removed from discarded equipment other than those mentioned in 16 02 15
16 03 04	inorganic wastes other than those mentioned in 16 03 03
16 03 06	organic wastes other than those mentioned in 16 03 05
16 06 04	alkaline batteries (except 16 06 03)
16 06 05	other batteries and accumulators
16 11 02	carbon-based linings and refractories from metallurgical processes others than those mentioned in 16 11 01
16 11 04	other linings and refractories from metallurgical processes other than those mentioned in 16 11 03
16 11 06	linings and refractories from non-metallurgical processes others than those mentioned in 16 11 05
17 01 01	Concrete
17 01 02	Bricks
17 01 03	tiles and ceramics
17 01 07	mixtures of concrete, bricks, tiles and ceramics other than those mentioned in 17 01 06
17 02 01	Wood
17 02 02	Glass
17 02 03	Plastic
17 03 02	bituminous mixtures other than those mentioned in 17 03 01
17 04 01	copper, bronze, brass
17 04 02	Aluminium
17 04 03	Lead
17 04 04	Zinc
17 04 05	iron and steel
17 04 06	Tin
17 04 07	mixed metals
17 04 11	cables other than those mentioned in 17 04 10
17 05 04	soil and stones other than those mentioned in 17 05 03
17 05 08	track ballast other than those mentioned in 17 05 07
17 06 04	insulation materials other than those mentioned in 17 06 01 and 17 06 03

17 08 02	gypsum-based construction materials other than those mentioned in 17 08 01
17 09 04	mixed construction and demolition wastes other than those mentioned in 17 09 01, 17 09 02 and 17 09 03
	MADE FROM WASTE MATERIALS OTHER THAN WASTE MATERIALS CLAIMED AS RECYCLED OR REGENERATED FROM WASTE MATERIALS OTHER THAN WASTE MATERIALS
19 01 02	ferrous materials removed from bottom ash
19 01 12	bottom ash and slag other than those mentioned in 19 01 11
19 01 18	pyrolysis wastes other than those mentioned in 19 01 17
19 01 19	sands from fluidised beds
19 02 03	premixed wastes composed only of non-hazardous wastes
19 02 10	combustible wastes other than those mentioned in 19 02 08 and 19 02 09
19 04 01	vitrified waste
19 05 01	non-composted fraction of municipal and similar wastes
19 05 02	non-composted fraction of animal and vegetable waste
19 05 03	off-specification compost
19 12 01	paper and cardboard
19 12 02	ferrous metal
19 12 03	non-ferrous metal
19 12 04	plastic and rubber
19 12 05	Glass
19 12 07	wood other than that mentioned in 19 12 06
19 12 08	Textiles
19 12 09	minerals (for example sand, stones)
19 12 10	combustible waste (refuse derived fuel)
19 13 02	solid wastes from soil remediation other than those mentioned in 19 13 01
20 01 01	paper and cardboard
20 01 02	Glass
20 01 08	biodegradable kitchen and canteen waste
20 01 10	Clothes
20 01 11	Textiles
20 01 34	batteries and accumulators other than those mentioned in 20 01 33
20 01 36	discarded electrical and electronic equipment other than those mentioned in 20 01 21, 20 01 23 and 20 01 35
20 01 38	wood other than that mentioned in 20 01 37
20 01 39	Plastics
20 01 40	Metals
20 01 41	wastes from chimney sweeping
20 02 01	biodegradable waste

20 02 02	soil and stones
20 03 01	mixed municipal waste
20 03 02	waste from markets
20 03 03	street-cleaning residues
20 03 07	bulky waste

## 2.3 The site

- 2.3.1 The activities shall not extend beyond the site, being the land shown edged in green on the site plan attached to the permit.
- 2.3.2 The activities shall not be carried out within 500 metres of a European Site or a SSSI.
- 2.3.3 No treatment of specified waste, unless undertaken in a building, shall take place within a specified AQMA.

## 3 – Emissions and monitoring

### 3.1 Fugitive emissions of substances

- 3.1.1 Fugitive emissions of substances (excluding odour and noise) shall not cause pollution. The operator shall not be taken to have breached this rule if appropriate measures, including, but not limited to, those specified in Table 3.1 below and any approved fugitive emissions management plan, have been taken to prevent or where that is not practicable, to minimise, those emissions.

Table 3.1 Appropriate measures for fugitive emissions

Measures	
1.	Unless stored or treated outside as specified waste <sup>3</sup> :
	a) all bulking, transfer or treatment of waste shall be carried out inside a building;
	b) all waste shall be stored in a building or within a secure container.
	c) all waste shall be stored and treated on an impermeable surface with sealed drainage system.
2.	Specified waste shall be stored and treated on hard standing or on an impermeable surface with sealed drainage system.

- 3.1.2 The operator shall:
- if notified by the Agency that the activities are giving rise to pollution, submit to the Agency for approval within the period specified, a fugitive emissions management plan;
  - implement the approved fugitive emissions management plan, from the date of approval, unless otherwise agreed in writing by the Agency.

<sup>3</sup> "specified waste" is defined in section 4.4 of these standard rules.

- 
- 3.1.3 All liquids, whose emission to water or land could cause pollution, shall be provided with secondary containment, unless the operator has used other appropriate measures to prevent or where that is not practicable, to minimise, leakage and spillage from the primary container.

## **3.2 Odour**

- 3.2.1 Emissions from the activities shall be free from odour at levels likely to cause pollution outside the site, as perceived by an authorised officer of the Agency, unless the operator has used appropriate measures, including, but not limited to, those specified in any approved odour management plan, to prevent or where that is not practicable, to minimise, the odour.

- 3.2.2 The operator shall:

- (a) if notified by the Agency that the activities are giving rise to pollution outside the site due to odour, submit to the Agency for approval within the period specified, an odour management plan;
- (b) implement the approved odour management plan, from the date of approval, unless otherwise agreed in writing by the Agency.

## **3.3 Noise and vibration**

- 3.3.1 Emissions from the activities shall be free from noise and vibration at levels likely to cause pollution outside the site, as perceived by an authorised officer of the Agency, unless the operator has used appropriate measures, including, but not limited to, those specified in any approved noise and vibration management plan, to prevent or where that is not practicable, to minimise, the noise and vibration.

- 3.3.2 The operator shall:

- (a) if notified by the Agency that the activities are giving rise to pollution outside the site due to noise and vibration, submit to the Agency for approval within the period specified, a noise and vibration management plan;
- (b) implement the approved noise and vibration management plan, from the date of approval, unless otherwise agreed in writing by the Agency.

# **4 – Information**

## **4.1 Records**

- 4.1.1 All records required to be made by these standard rules shall:

- (a) be legible;
- (b) be made as soon as reasonably practicable;
- (c) if amended, be amended in such a way that the original and any subsequent amendments remain legible or are capable of retrieval; and
- (d) be retained, unless otherwise agreed by the Agency, for at least 6 years from the date when the records were made, or in the case of the following records until permit surrender:
  - (i) off-site environmental effects; and
  - (ii) matters which affect the condition of land and groundwater.

- 4.1.2 All records, plans and the management system required to be maintained by these standard rules shall be held on the site.

## **4.2 Reporting**

- 4.2.1 All reports and notifications required by these standard rules shall be sent to the Agency using the

## **Environment Agency Permitting decisions**

We have decided to grant a permit to Derwen Plant Ltd for Neath Abbey Wharf, Neath Abbey, Neath, SA10 6BL

The permit number is **EPR/FP3893SF**

The operator is **Derwen Plant Ltd**

The facility is located at **Neath Abbey Wharf, Neath Abbey, Neath, SA10 6BL**

The decision was effective from **9<sup>th</sup> March 2010**

### **Summary of the decision**

We have decided to grant a permit for the operator, subject to the conditions in the permit.

We consider in reaching that decision we have taken into account all relevant considerations and legal requirements and that the permit will ensure that the appropriate level of environment protection is provided.

When referred to in an environmental permit, these rules will allow the operator to operate a Household, Commercial and Industrial Waste Transfer Station with waste treatment at a specified location, provided that the permitted activities are not carried out within 500 metres of a European Site, Ramsar site or a Site of Special Scientific Interest (SSSI). Furthermore, specified waste cannot be treated outside a building within a specified Air Quality Management Area (AQMA).

Permitted wastes are limited to non-hazardous wastes and do not include hazardous wastes such as asbestos. The total quantity of waste that can be accepted at a site under these rules must be less than 75,000 tonnes a year. With the exception of specified waste, all bulking, transfer or treatment of nonhazardous waste must be carried out inside a building. Wastes can be bulked up for disposal or recovery elsewhere and can also be treated by sorting, separation, screening, baling, shredding, crushing and compaction. These rules will not permit the burning of any wastes, either in the open, inside buildings or in any form of incinerator.

These rules do not allow any point source emission into surface waters or groundwater. However, under the fugitive emissions of substances rule:

- Liquids may be discharged into a sewer subject to a consent issued by the local water company.
- Liquids may be taken off-site in a tanker for disposal or recovery.
- Clean surface water from roofs, or from areas of the site that are not being used in connection with storing and treating waste, may be

discharged directly to surface waters, or to groundwater by seepage through the soil via a soakaway.

## **Permit**

**The Environmental Permitting (England & Wales) Regulations 2007**

---

**Derwen Plant Ltd**

**Derwen Plant Ltd  
Neath Abbey Wharf  
Neath Abbey  
Neath  
SA10 6BL**

**Permit number**

**EPR/FP38936F**

**Permit**

The Environmental Permitting (England and Wales) Regulations 2007

## Permit

Permit number  
**EPR/FP3893SF**

The Environment Agency hereby authorises, under regulation 13 of the Environmental Permitting (England and Wales) Regulations 2007

**Derwen Plant Ltd** ("the operator"),  
whose registered office is

**Neath Abbey Wharf  
Neath Abbey  
Neath  
SA10 6BL**

company registration number **03104740**

to operate a standard facility described in standard rules **SR2008No3\_75kte** at

**Derwen Plant Ltd  
Neath Abbey Wharf  
Neath Abbey  
Neath  
SA10 6BL**

to the extent authorised by and subject to the conditions of this permit.

Under regulation 27(2) of the Regulations, standard rules **SR2008No3\_75kte** are conditions of this permit.

Name	Date
	9 <sup>th</sup> March 2010

Authorised on behalf of the Agency



# Schedule 1 - Site plan

This is the plan referred to in the standard rules SR2008No3\_75kte

DER/MAN/2

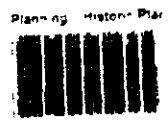
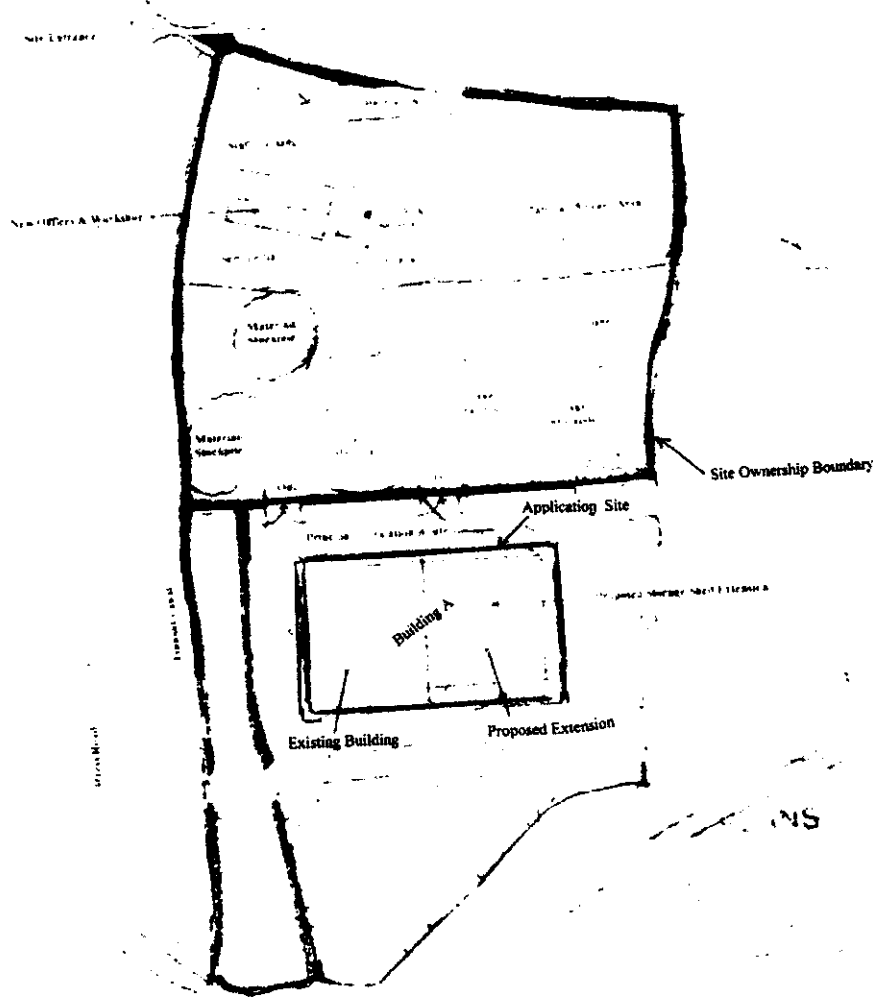

AMENDED SITE LAYOUT - PLAN EJA 17401  
CHANGING USE TO MATERIALS RECYCLING FACILITY  
FORMER COAL WASHERY YARD (SOUTHERN PART)  
NEW ABBEY WHARF SKEWES, SEATH.